



EXCEPTIONAL WOOD
& MULTI-FUEL STOVES

charnwood 



contents

INTRODUCTION	3	<i>Cove 2b</i>	58
<i>Wood & multi-fuel heating</i>	4	<i>Island IIIb</i>	60
TOR	6	<i>Country 16b</i>	62
<i>Tor Pico</i>	8	<i>SLX</i>	64
<i>Tor</i>	10	FLUE BOILERS	66
COVE	12	INNOVATION	68
<i>Cove 1</i>	14	<i>Converting grate</i>	68
<i>Cove 2</i>	16	<i>Reciprocating grate</i>	68
<i>Cove 3</i>	18	<i>Quattroflow® system</i>	68
ISLAND	20	<i>Central heating control system</i>	68
<i>Island I</i>	22	<i>Ash carrier</i>	69
<i>Island II</i>	24	<i>Heatshields</i>	69
<i>Island IIct</i>	26	<i>Vertical rear flue adaptor</i>	69
<i>Island III</i>	28	<i>External air manifold</i>	69
BAY	30	COLOUR	69
<i>Bay 5</i>	32	COMPARISON CHART	71
<i>Bay 5GT</i>	34	STOVE SELECTOR	72
C-SERIES	36	SPECIFICATIONS	
<i>C-Four</i>	38	<i>Tor</i>	74
<i>C-Five</i>	40	<i>Cove</i>	74
<i>C-Six</i>	42	<i>Island</i>	74
<i>C-Seven</i>	44	<i>Bay</i>	76
<i>C-Eight</i>	46	<i>C-Series</i>	76
COUNTRY	48	<i>Country</i>	78
<i>Country 4</i>	50	<i>Boilers</i>	79
<i>Country 6, 8 & 12</i>	52	<i>SLX</i>	79
SLX	54	ANKI CHIMNEY SYSTEMS	81
BOILER MODELS	56	BODJ FAIR TRADE	82

charnwood



CHARNWOOD is a privately owned family business based on the Isle of Wight. Established in 1972 we have become one of the foremost stove companies in Europe specialising in the manufacture of fine fires and stoves. As a company we believe in taking a strong ethical approach to every area of our business; whether it be in how we design and build our stoves, how we treat our customers or the impact our products have on the environment.

Our stoves are designed and built to last. Even forty years after building our first stove there are still many of our original models giving good service as they continue to heat peoples' homes. We believe that this is how it should be; whilst not everybody will want a forty year old stove it is good to know that an investment in a Charnwood is more than a short term relationship.

Our company ethos includes buying, where possible, from local UK based suppliers. Our stoves are built in our own factory here on the Isle of Wight and are manufactured using a combination of high-tech precision machinery and skilled hand working. Many of our employees have been with us for over 25 years and have seen the company grow from an operation producing a few hundred stoves a year to one making many thousands of units that are sold worldwide. Affirming this achievement we were recently awarded The Queen's Award For Enterprise: International Trade.

Part of the success of Charnwood has been due to the loyal following of our customers. We always try to give first class service, to look after our customers and to ensure their needs are met. Whether it is for advice on installation, reassurance on operation or the need for spare parts we always strive to put the customer first. As a family business, with nine family members working in the company, we recognise the need for personal attention to detail and we always seek to give just that.

We hope you enjoy this brochure. In it you will find a wide range of our fires and stoves. Whichever one you choose we can guarantee you years of comfort and warmth, a product designed to bring a hearty welcome into your home.



charnwood WOOD & MULTI-FUEL HEATING

There is nothing quite the same as heating your home with a real Charnwood fire. Not only does the ritual of loading a stove give a greater sense of achievement and satisfaction, it provides a warmth that no other energy source can equal. The benefits are numerous: a Charnwood stove will 'breathe' allowing the heat to seep into the very fabric of your home - the constant source of heat and continual air changes reduce condensation; and by burning renewable fuels such as wood you are participating in a natural cycle that is of great benefit to our environment.

We at Charnwood have unrivalled in-depth knowledge of real-fire heating and continue to invest a great deal of time and money into innovative stove design and development. Our appliances are a result of our intense research and over the years we have been at the forefront of the new generation of clean burning ultra efficient stoves. These are advanced appliances that deliver a reliable burn providing warmth to the whole of your property and all with an amazing degree of control, economy and environmental friendliness. The bodies of our wood-burning and multi-fuel stoves are British built from

the best combination of materials for durability and design aesthetics: plate steel, cast iron, fire brick and ceramic glass. These materials offer the best in strength and versatility with excellent heat retention properties. They also allow the stove to be tightly sealed ensuring optimum control over the burning rate - close down the air supply for a gentle slumber or open it right up for an intense, blazing fire. The throat plate on all of our models can be taken out with ease, enabling the cleaning of the flueways and the chimney without the inconvenience of removing other internal fireparts. All our stoves are designed and tested to EN 13240:2001, ensuring the very best in efficiency, safety, design and construction. When purchased through an authorised stockist the bodies of our stoves are guaranteed for 10 years (with the exception of our boiler models which are guaranteed for 3 years) and all non-consumable body parts are guaranteed for 2 years.

CLEAN-BURN AIR-WASH All the wood-burning and multi-fuel stoves featured in this brochure incorporate the latest clean-burn and air-wash technology. This means when burning your choice of fuel the volatile by-products emitted by the initial burning are re-ignited and burnt again in the fire. This double combustion subsequently reduces emissions and ash deposits and delivers even more warmth to your room. Altogether a



cleaner home, a cleaner chimney and much cleaner for our environment. In addition to this, the clean-burn airwash also keeps the glass doors beautifully clear, giving you an uninterrupted view of the fire.

VERSATILITY A centrally located stove can heat a home of moderate size or for larger homes our range of add-in boilers or central heating models can provide full home heating including domestic hot water. Within the Charnwood range there is a model to suit every home and individual requirement. For the ultimate in contemporary home heating we offer the Tor (page 6), the Cove collection (page 12) and our new insert stove the Bay (page 30). For a classic interior we offer the Island collection (page 20) and the C-Series (page 36). For traditional homes we have the Country range of stoves (page 48) or for a more modern feel we offer the SLX (page 54).

ENVIRONMENT It is a fact that our global fossil fuel energy reserves are finite and should be used sensibly. The burning of wood on a Charnwood stove makes great environmental sense for a number of powerful reasons:

Wood is one of the few renewable fuels. Growing trees for fuel is a viable and sensible option. Using wood means we are preserving our valuable fossil fuel reserves for future generations.

Trees consume as much, if not more CO₂ when they grow as they emit when they burn. So providing there is managed replanting, heating with wood is a positive way to reduce CO₂ emissions. This is in stark contrast to all fossil fuels.

Governments throughout the world are committed to reducing CO₂ emissions: with a Charnwood you too can play a part in this.

When you burn wood on a highly efficient Charnwood stove you reduce the need for other forms of heating and in turn do your bit to save fossil fuels, CO₂ emissions and the planet!

As well as the environmental benefits a Charnwood stove also gives you the freedom from dependence on the large energy utilities. At a time when there is increasing concern over stability of supply throughout the world it is nice to know that a Charnwood gives, in a most beautiful way, that certainty of warmth during periods of interrupted supply.



TOR

The TOR is a contemporary wood burning stove from Charnwood. Three

gently curved glass panels offer a spectacular view of the fire from the front and from the sides whilst a highly advanced combustion system ensures exceptional clean burning and outstanding efficiency. The Tor is available in 2 sizes: The Tor (3-10kW) and The Tor Pico (2-7kW). Both models employ the latest smoke reducing technology - allowing wood to be burnt in smoke control areas.



Optional bevel edged stone top gives an alternative look and also stores heat.

Cool-to-touch handle for safe and easy re-loading.

Charnwood's renowned riddling grate for optimum burning efficiency and clean de-ashing directly into an ingenious combined ash pan and carrier for safe and dust free disposal.

Charnwood's patented Quattroflow® air management system. One simple control to introduce air to just the right places and in just the right amounts. Simply pull out to burn faster or push in to slow it down (see page 68).



The TOR and TOR Pico are designed and built to conform to EN13240:2001 and meet the UK building requirements for installation with a 12mm non-combustible hearth.



TOR PICO



The Charnwood Tor Pico is the latest addition to the Tor range delivering 2-7kW to the room. With a rated output of 5kW it is, in certain situations, exempt from the British building regulation to have an additional air supply into the room. However for further comfort and efficiency the Tor Pico incorporates an integrated external air connection. See pages 74 and 69 for full specification and colour options.



TOR PICO



TOR (see page 10)





TOR

The original Charnwood Tor delivers a respectable 3-10kW of heat to your room. The Tor is designed to maximise the view of the fire whilst simplifying the burning process. See pages 74 and 69 for full specification and colour options.



TOR PICO (see page 8)



TOR





The Cove collection is one of Charnwood's most successful range of wood burning stoves: a union of the very best features of our past and present stoves finished with a soft contemporary edge. One single, curved door offers a breathtaking view of the fire whilst its highly advanced combustion system ensures optimum efficiency and an exceptionally clean burn - ensuring more heat from less fuel.

Whilst the Cove is sophisticated in design it is incredibly simple to operate. One multi-functional tool is used to open the door, de-ash and empty. It features Charnwood's un-rivalled multi-fuel converting grate, advanced clean-burn technology and the patented Quattroflow[®] air management system (see page 68). An optional external air manifold* is also available enabling an outside air supply to be channelled directly into the stove through the rear of the Quattroflow[®] box (see page 69). The Cove stove is available in three sizes with a choice of five base options and eight Charnwood Colours (see page 69). Optional convection panels are also available for each of the stoves. These gently convect heat into the room and reduce distances to combustables to 250mm. The panels are available in Charnwood's standard stove colours or a gloss black vitreous enamel finish allowing you to customise by mixing it up with contrasting colours. Smoke reducing (sr) models are also available within the Cove range. These are DEFRA exempted appliances - allowing wood to be burnt in smoke control areas.



OPTIONAL SIDE CONVECTION PANELS & REAR HEAT SHIELD



THREE OUTPUTS



FIVE BASE OPTIONS



CONVERTING GRATE

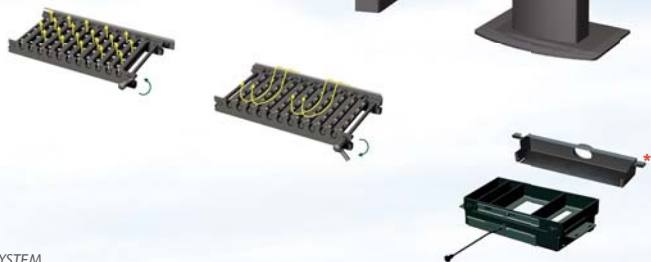

QUATTROFLOW® AIR MANAGEMENT SYSTEM



All Cove stoves have been independently certified to conform to EN 13240:2001 and meet the UK building requirements for installation with a 12mm non-combustible hearth.





The COVE 1 is the smallest in the COVE family. With simple clean lines and a single door, giving an excellent view of the fire, the Cove 1 is ideal for the smaller room. With its fully controllable Quattroflow® air management system it provides between 2 and 6kW of heat with superb efficiency. With a rated output of 4kW the COVE 1, in certain situations, can be installed without the need for external air. The colour (see page 69), base options and convection panels make this a very versatile stove setting new standards in the small stove arena.



The COVE 1sr is a separate smoke reduction model that is DEFRA exempted for burning wood in smoke control areas.



Top: Almond COVE 1 with store stand • Opposite: Black COVE 1 with store stand, Bodj Lotus log holder (see page 82)
Above L-R: COVE 1 shown with optional convection panels; with low stand, low arch, midi stand, store stand & centre stand.
Further specifications on page 74





With its gentle curved door and soft lines the Charnwood COVE 2 creates a powerful centre point for any room. It delivers a respectable 8kW of heat with a maximum output of 11kW. The base options (as pictured below) give the stove five very different looks. The low stand and low arch are perfect for fitting the appliance into a standard fireplace opening whilst the store stand and centre stand are ideal for a large inglenook or a freestanding situation. Optional convection panels are also available.



The COVE 2sr is a separate smoke reduction model that is DEFRA exempted for burning wood in smoke control areas.



Top: Brown COVE 2 with centre stand • Opposite: Black COVE 2 with store stand
Above L-R: COVE 2 shown with optional convection panels; with low stand, low arch, midi stand, store stand & centre stand.
Further specifications on page 75





The Charnwood COVE 3 is the largest stove in the Cove range. With a rated output of 12kW and a maximum of 16kW it is ideally suited to a larger room, hall or open plan area. The Cove 3 is able to take a log length of up to half a metre and with its tall curved door offers a spectacular view of the fire. Once again it comes with a versatile choice of five base options, convection panels and eight colour ways to suit different situations.



Top: Bronze COVE 3 with store stand • Opposite: Almond COVE 3 with store stand
Above L-R: COVE 3 shown with optional convection panels; with low stand, low arch, midi stand, store stand & centre stand.
Further specifications on page 75



ISLAND

The Charnwood Island range sets the definitive standard for clean-burning multi-fuel stoves. When this collection was launched it revolutionised multi-fuel home heating creating the benchmark in environmentally clean-burn, single controlled stoves. The result is highly sophisticated simplicity. What sets the Island stoves apart from all other multi-fuel stoves are its unique and exceptional features:

- One simple air control - the Quattroflow® - push in to burn slower, pull out to burn faster.
- A 'cool to touch' handle for safe and easy reloading.
- The ultimate multi-fuel grate for burning your chosen fuel at optimum efficiency (see right).
- Clean-burn, air-wash system using preheated air for combustion purposes which ensures clean glass & reduced emissions.
- Firebrick lined and made from the best combination of 5 and 10mm plate steel, cast iron and ceramic glass.
- Drop-down throat plate for enabling the chimney to be swept through the stove.
- The ability to burn wood logs in smoke control areas if fitted with a smoke reduction kit.

The Island stove is available in three sizes, with an option of high legs or a store stand and in a choice of eight Charnwood Colours (see page 69)



THREE OUTPUTS



STORE STAND &
HIGH LEG OPTIONS



CONVERTING GRATE

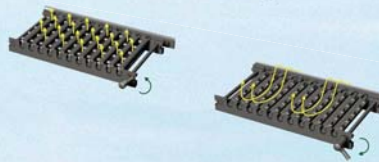

QUATTROFLOW® AIR MANAGEMENT SYSTEM

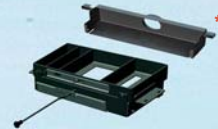

CE All Island stoves have been independently certified to conform to EN 13240:2001 and meet the UK building requirements for installation with a 12mm non-combustible hearth.





The Charnwood Island I is the smallest stove in the Island collection. Its uncomplicated looks and gentle curves ensure it sits well in any situation; be it modern or traditional. Delivering an output of 2-7kW of heat it can take a log length of up to 370mm (14.5"). With a rated output of 5kW the Island I, in certain situations, can be installed without the need for external air. For further specifications and colour options turn to pages 74 & 69.



This stove may burn wood logs in smoke control areas if fitted with a smoke reduction kit (contact your local stockist for details).



Top and opposite: Almond and Black ISLAND I • Above, L-R: standard ISLAND I, with high legs, with store stand





The Charnwood Island II is the middle stove in the Island collection. With a slightly larger view of the fire it still retains its clean-line proportions while producing a rated 8kW of heat to the room. It can take a log length of up to 440mm (17"). For further specifications and colour options turn to pages 74 & 69.



This stove may burn wood logs in smoke control areas if fitted with a smoke reduction kit (contact your local stockist for details).



Top: Black ISLAND II with high legs and Black ISLAND II with store stand. Opposite: Almond ISLAND II. Above, L-R: standard ISLAND II, with high legs, with store stand.







The ISLAND IICT is based on the successful Island II and features a built in soap stone cooking top under a removable steel plate that doubles as an easy-clean splash back when you cook. The stove was designed for the increasingly popular open-plan living areas in today's homes - merging the boundaries of cooking, dining and lounging.



This stove may burn wood logs in smoke control areas if fitted with a smoke reduction kit (contact your local stockist for details).



Opposite: Black ISLAND IIct with high legs • Above, L-R: standard ISLAND IIct, with high legs, with store stand.



The Charnwood Island III is the largest stove in the Island collection. Its majestic proportions make it ideal for larger rooms and open plan areas. Exuding a rated 12kW of heat, this is a stove that can take an incredible log length of over half a metre. The Island III offers a spectacular view of the fire. A true wide-screen experience. For further specifications and colour options turn to pages 75 & 69.



This stove may burn wood logs in smoke control areas if fitted with a smoke reduction kit (contact your local stockist for details).





BAY

The BAY is the definitive new insert wood burning stove from Charnwood. The stove features a large landscape

window framed with a gently curved surround. Delivering 5kW of heat to the room the Bay features new burn technology and is incredibly simple to operate with one single air control and a cool-to-touch handle.

The Bay is available in two options: The standard Bay 5 and the BAY 5GT - a deluxe version featuring Charnwood's renowned converting grate (see page 68) and a convection fan for effective heat distribution to the room.



Built from the best combination of cast iron, plate steel and ceramic glass the BAY is brick lined and is designed for easy installation.

Cool-to-touch handle and air controls for safe operation and re-fuelling.

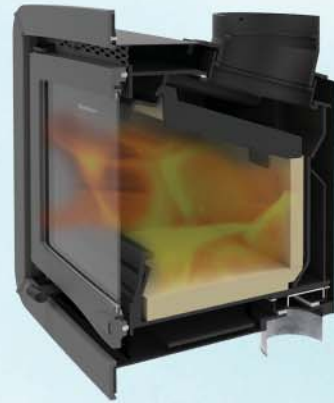

The BAY GT features Charnwood's renowned riddling grate for optimum burning efficiency and clean de-ashing.

It also features an electric convection fan for improved heat distribution to the room.



CE The BAY 5 and BAY 5GT have been independently certified to conform to EN 13229:2001







The Bay 5 is Charnwood's latest insert stove. Built from the best combination of cast iron, plate steel and ceramic glass the stove is brick lined and is designed for easy installation. An optional fireplace trim is also available. It is available in a choice of eight colours.



This stove meets the DEFRA requirements for smoke control exemption; allowing wood to be burnt in smoke control areas.



BAY 5GT

The Bay 5GT is built to the same specification as the standard Bay 5 but includes Charnwood's renowned converting grate and a convection fan for effective heat distribution to the room.



This stove meets the DEFRA requirements for smoke control exemption; allowing wood to be burnt in smoke control areas.









The C-Series is Charnwood's latest innovation. A range of classically styled wood burning stoves that feature one single air control and an integrated inlet for ducting external air to improve performance and efficiency.

The C-Series stoves deliver an exceptionally clean burn with outstanding efficiency and can be fitted with a drop-in multifuel grate for burning solid fuel and an optional store stand to raise the stove off the ground. A rear heat shield is also available enabling the stove to be placed closer to the wall.



All C-Series models are designed to meet DEFRA requirements for smoke control exemption; allowing wood to be burnt in smoke control areas.



All C-Series stoves have been independently certified to conform to EN 13240:2001 and meet the UK building requirements for installation with a 12mm non-combustible hearth.



Featuring a large picture window the C-Four is the smallest model in the C-Series delivering a heat output to the room of between 2 to 5.5kW. The stove is steel plate lined and can take a log length of up to 255mm (10"). With a rated output of 4.9kW the C-Four, in certain situations, can be installed without the need for external air. For further specifications and options turn to pages 69 & 76.



This stove meets the DEFRA requirements for smoke control exemption; allowing wood to be burnt in smoke control areas.









The C-Five is one of the latest additions to the C-Series. with a similar output to the C-Four it is built with landscape proportions to take a slightly longer log length; 305mm (12"). The stove is fire brick lined and in certain situations, can be installed without the need for external air due to its rated output of 5kW. For further specifications and options turn to pages 69 & 77.



This stove meets the DEFRA requirements for smoke control exemption; allowing wood to be burnt in smoke control areas.





The C-Six is a 6.7kW stove delivering between 5 and 7kW of heat to the room. The stove is steel plate lined and can take a log length of up to 255mm (10"). For further specifications and options turn to pages 69 & 77.



This stove meets the DEFRA requirements for smoke control exemption; allowing wood to be burnt in smoke control areas.



Top: Almond C-Six • Opposite: Black C-Six • Above, L-R: C-Six, with store stand, optional drop-in grate.





The C-Seven is another new addition to the C-Series. Just like the C-Five it is built with a wide picture window and landscape proportions to take a longer log length; 380mm (15"). The stove has a rated output of 7.6kW and is fire brick lined. For further specifications and options turn to pages 69 & 76.



This stove meets the DEFRA requirements for smoke control exemption; allowing wood to be burnt in smoke control areas.









The C-Eight is the largest stove in the C-Series. With an 8.3kW output the stove features an impressive portrait picture window and takes a 305mm (12") log. Lined with plate steel the C-Eight is suited to larger fireplaces and living spaces. Further specifications and options can be found on pages 69 & 77.



This stove meets the DEFRA requirements for smoke control exemption; allowing wood to be burnt in smoke control areas.



The C-Eight stove was selected by the Prince's Foundation to appear in the Prince's House at the 2013 Ideal Home Show in conjunction with House Beautiful magazine.







The Charnwood Country collection is our well established range of traditional wood and multi-fuel burning appliances.

Our Country stoves have acquired an excellent reputation over the years having been installed in thousands of homes across the globe.

The single door Country 4 has gained an almost cult following, whilst the distinct double angled doors, of the other Country models, has established this range as a true classic.

As with all the stoves in this brochure the Country range incorporates superb clean-burn technology for ultra efficient and eco-friendly home heating. There is a stove in this range for virtually every home heating requirement; from a small room heating stove to a full central heating boiler model.

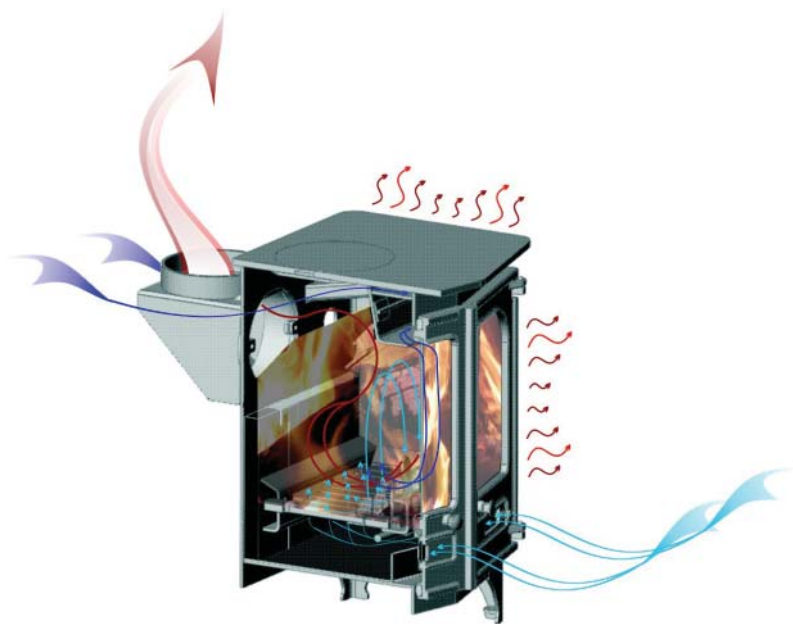

The Country collection is essentially a range of wood-burning stoves (with the exception of the boiler models which are true multi-fuel stoves). However we do offer an optional reciprocating grate (see page 68). This is an easily fitted, drop in system that converts a Country wood-burner into a multi-fuel stove should you wish to burn coal or smokeless fuels. When installed, solid fuel will burn more efficiently by allowing the air to flow under the fire bed. Its neat, external riddling action and ash pan ensure easy cleaning and keep mess to a minimum.



All Country dry stoves have been independently certified to conform to EN 13240:2001

Opposite L-R: Black Country 4, Country 16b, Country 8, Country 6
Above: Country 6 cutaway showing clean-burn airflow



4 country

The Country 4 is the smallest model in the wood & multi-fuel room heating collection, yet still incorporates the ingenious features of the larger stoves. It is a neat, sturdy, yet graceful little fire and with a rated output of 4.8kW can be installed in certain situations, without the need for external air. The single door gives a complete and clear view of the fire and features a spinning primary air wheel for optimum control over the burning rate. In spite of its size, the Country 4 takes a decent sized log length of 330mm (13") making it a very popular choice in the small stove market. An optional back boiler can be fitted

to heat your domestic hot water or a couple of small radiators. We also offer an easily fitted drop-in riddling grate should you wish to burn coal or smokeless fuels. A small clip-on front shelf can also be fitted and we now offer an optional decorative front fence for a more traditional look. The stove is available in a choice of eight Charnwood colours (see page 69) and finished with touches of solid brass and a turned wooden door handle.

This stove may burn wood logs in smoke control areas if fitted with a smoke reduction kit (contact your local stockist for details).



Top: Almond Country 4 • Opposite Black Country 4 with optional decorative fence • Above L-R • Country 4, with optional shelf, with optional decorative fence, optional drop-in grate • Further specifications on page 78





6 country

The Country 6 produces a stunning 6kW of heat. Being the next step up within the Country collection it features large, twin angled doors to optimise the view of the fire. The Country 6 has a robust construction featuring a brick lined fire box with the ability to burn 380mm (15") logs. The detachable tool handle that operates the doors ensures maximum safety. Once again it has the option of

a reciprocating grate and a small back-boiler to provide domestic hot water or to heat around two radiators. This model also comes with the option of a clip-on shelf as well as a slide-on canopy for a very different look altogether. Yet again the stove is finished with touches of solid brass and is available in a choice of eight shades of colour (see page 69).



8 country

The Country 8 has always been a very popular choice of stove, delivering around 8kW of heat to the room. Once again it has large twin doors and comes complete with a fixed front shelf. All the standard features apply: air wash, clean burn technology and brick firebox lining, as well as

an optional canopy to transform its looks, riddling grate, back-boiler and choice of colours (see page 69). This is an exceptional stove and, as many existing customers will tell you, an excellent investment to the home. Come back to embracing warmth.



12 country

The Country 12 is the largest in our Country roomheater range. With a rated output of 12kW it is well suited to a larger room or an open plan area. It blazes with superb, clean-burn, efficiency coupled with minimum mess, leaving your home thoroughly warmed.

It takes a large log size of up to 430mm (17"). The options of a slide-on canopy, back-boiler, drop-in riddling grate and choice of colours (see page 69) all apply. As with all the stoves in the Country range the 12 is built from a substantial combination of the best materials and enhanced with touches of solid brass.







The Charnwood SLX 20 is a multi-fuel stove with a more contemporary feel and sophisticated operation. It

simplifies the real fire process: burning less fuel, more cleanly with maximum efficiency and low emissions. It is available in a number of sizes to suit your specific heating needs: from a pure room heater through to full central heating (see page 68). All this whilst retaining a simple, stylish look.

The SLX 20 has been carefully designed to get the very best out of the fuel that is burnt. This can be wood, coal, smokeless fuel, briquettes or even peat. All these fuels can be burnt at optimum efficiency, on the well-proven Charnwood multi-

fuel grate. This is the same grate used in our Country 16b and all Cove and Island models: the best grate system on the market. Simple, clean and highly effective (see page 68). The cast iron and plate steel exterior is finished in either gloss black vitreous enamel (as pictured above) or a durable matt stove paint (pictured opposite in black but also available in eight Charnwood colours - see page 69).

The SLX 20 is purely for room heating delivering up to 5.4kW of heat. It is fully controllable with a built in thermostat to regulate the heat output to the room. Both the inset and freestanding models come with the option of a small add-in-boiler to heat the domestic hot water.







CHARNWOOD'S range of boiler stoves are designed specifically for those wishing to run a full central heating system. The benefits of

a 'real fired' central heating system as opposed to gas, electric or oil are numerous: the constant heat source, elimination of condensation and the continual air changes caused by a 'breathing' heating appliance, are far more beneficial to health and well-being than its counterparts. The high efficiency of these Charnwood boilers also offers significant environmental benefits; producing less CO₂ emissions than an equivalent

gas or oil boiler. As with all our wood and multi-fuel burning models we incorporate an airwash system which will ensure superb clean-burning and a clear view of the fire at all times regardless of what fuels are burnt. The 2B, IIIb, 16b and SLX stoves also feature our unrivalled riddling grate as standard to allow easy removal of ash. The grate can also be opened slightly to increase burning rate when required. The reputation of our boiler models is unrivalled in the market place and we are widely considered to be the clear market leaders in this field.

BOILER SIZING

Our boiler stoves conform to the EN13240 standard and we publish these results in the relevant guides. When choosing a boiler stove it is important to find the correct stove for your system and to compare each stove on the same basis. These are some of the factors you should take into account:

STOVE OUTPUT: This is measured in terms of kW output to the boiler and kW output to the room. The outputs quoted are those of the EN13240 test. In the home situation these outputs and the split will be dependant on a number of factors such as:

Fuel used - wood generally shows a higher ratio of heat to room (you can see the flame when the fire is turned up therefore more radiant heat is emitted). There are also variations in different types of solid fuel – we generally test on anthracite.

State of the fire - in slumber mode there will be a higher heat to the boiler and less to the room. Over time the outputs also vary (see example graphs opposite)

Reloading time - our tests are carried out using reloading times of 1½ hours for wood and 4 hours for solid fuel. If you load more often you will get a higher output, less often will give you a lower output. In reality when your system is cold your loading interval will be shorter. Once the system is up to temperature you will load at much longer intervals as you are just 'topping' the system up.

NUMBER OF RADIATORS: This is a very rough guide. For solid fuel we assume 3kW for hot water and around 1kW for each radiator. For wood burning we calculate this differently as the burning profile (see graph) is different. **It is very important that you ask your heating engineer to determine the correct size** – for example in some calculations the 16b can be said to heat up to 17 radiators!

As you can see, unlike a gas or oil boiler a solid fuel boiler has a lot of different variables which affect its heat output. Therefore when choosing a boiler it is important to consider how the outputs are arrived at. In the UK the HETAS guide allows you to compare heat outputs and refuelling times on tested products. For details on these visit www.hetas.co.uk

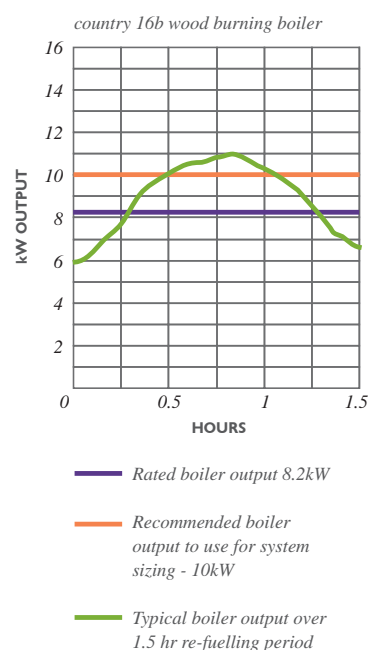
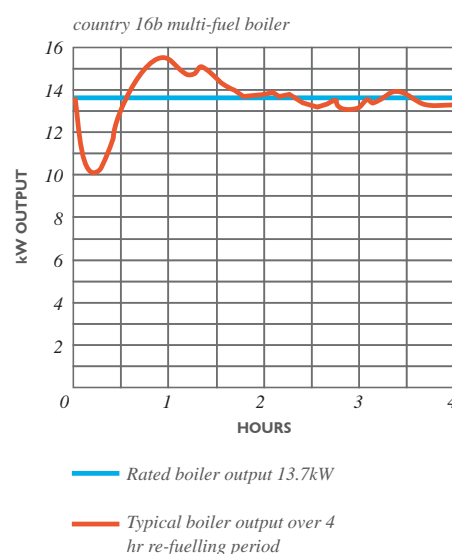



The COVE 2B is the latest addition to Charnwood's unrivalled range of biomass and multi-fuel boiler stoves.

Based on our contemporary Cove stove the COVE 2B incorporates a thermostatically controlled integral boiler sufficient to power up to 7 radiators plus domestic hot water. The stove features Charnwood's clean burn air wash system and renowned converting grate (page 68) for optimum fuel flexibility and easy ash removal.



CE The Cove 2B has been independently certified to conform to EN 13240:2001 and meets the UK building requirements for installation with a 12mm non-combustible hearth.

Opposite: Gunmetal Cove 2B. Further specifications on page 79
Colour specifications on page 69







The Island IIIb wood burning boiler stove is the ultimate in biomass heating. Equipped with the renowned Charnwood converting grate (page 68) for easy ash removal and fully boiler sensitive thermostatically controlled the Island IIIb combines leading edge boiler technology with its exceptional aesthetic design. As an integral boiler stove it is optimised to heat between 6 and 9 radiators plus hot water ensuring exceptional performance. It has a total output of 18kW and also features the 'cool to touch' handle and has the ability to burn logs up to 550mm.



The Island IIIb has been independently certified to conform to EN 13240:2001 and meets the UK building requirements for installation with a 12mm non-combustible hearth.





THE COUNTRY 16b

Woodburner is a fully fledged biomass central heating

boiler. The total output is

15.9kW; 8.6kW to the water and 2-8kW to the room. This model will run around 7 radiators and supply all domestic hot water. It features the riddling grate to ensure easy ash removal and Charnwood's standard clean burn technology for ultra efficient burning. This model also features a water-temperature-sensitive thermostatic control which enables this stove to be used alongside sophisticated central heating controls. An optional canopy is also available.



THE COUNTRY 16b Multi-fuel delivers heat suitable for heating domestic hot water plus around 10 radiators. It

has a total output of 19.6kW providing 13.2kW to the water and 2-8kW to the room. Once again it is thermostatically controlled with a multi-fuel riddling grate allowing a wide range of solid fuels to be burnt. Its deep fire bed allows solid fuel to be loaded up for excellent overnight burning performance. Despite burning solid fuels this boiler model can still offer significant environmental benefits. For example where a 50/50 mixture of wood and coal is burned the net CO₂ emissions can be reduced to less than an equivalent gas, electric or oil boiler.* Increase the percentage of wood and the savings are even greater.



The Country 16b wood burning and multi-fuel models have been independently certified to conform to EN 13240:2001 and meet the UK building requirements for installation with a 12mm non-combustible hearth.

* Taken from 'Multi-fuel Heating & The White Paper' copies available online at www.charnwood.com • Further specifications on page 79. Colour specifications on page 69





The SLX 45 has identical looks and features to that of the SLX20, but features a thermostatically

controlled, integral boiler that delivers a heat output sufficient to power 8-9 radiators and ample hot water. Because it is fitted with a water temperature sensitive thermostat, heating controls (such as the Charnwood Central

Heating Control System - page 68) can be fitted, to give heat precisely when and where it is needed.

Once again it is available as an inset or freestanding appliance with a choice of a matt paint finish (eight colour options - see page 69) or gloss black vitreous enamel.

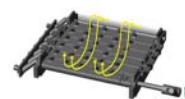

charnwood FLUE BOILER

The flue boiler is one of Charnwood's latest home heating innovations. This revolutionary stove addition replaces the first few feet of the standard flue rising from the top of the stove and utilises the excess heat from the appliance that would otherwise be lost. In addition to this because the boiler is external the stove maintains its high clean-burn combustion efficiency. Depending on the size of stove and subsequent flue boiler, outputs of between 1.8 and 3.4 kW can be achieved with minimal effect on the nominal output of the stove. This can provide sufficient heat for domestic hot water and up to 3 radiators. The flue boiler comes in 3 sizes to fit all Tor, Cove, Island, C-Series and Country dry models.

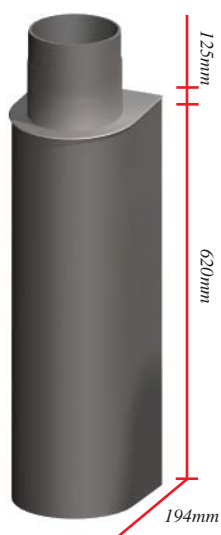

125mm (5")

1.8kW nominal output

Heating capacity:
DHW or 2 rads

Suitable for:
Cove 1
C-Four, Five
Country 4



150mm (6")

2.4kW nominal output

Heating capacity:
DHW + 1 rad

Suitable for:
Tor Pico
Cove 2
Island I, II
C-Six, Seven, Eight
Country 6,8,12

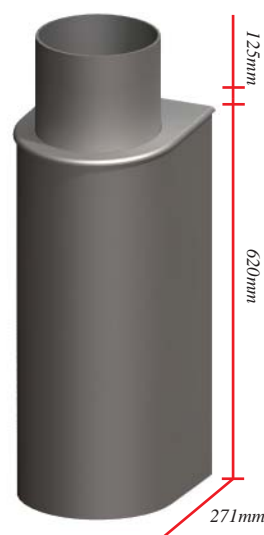

178mm (7")

3.4kW nominal output

Heating capacity:
DHW + 3 rads

Suitable for:
Tor
Cove 3
Island III



Cove 1 with flue boiler

CONVERTING GRATE

The Charnwood multi-fuel converting grate is the very best grate system on the market. Built into all Cove, Island, Bay GT, SLX and Country 16b models, the grate can be altered to ensure the most efficient burning conditions. By operating a lever on the side of the stove, with the tool provided, a series of grate bars can be set into a closed, flat bed position (the most efficient way to burn wood) or to an open grate for ultra efficient burning of coal and smokeless fuels. This grate also acts as a highly effective riddling mechanism, neatly dropping the ash into the wall-to-wall pan below for clean disposal. Because the grate is operated externally all of these manoeuvres can be carried out with the doors closed and when the stove is fully loaded and under fire.

CLOSED POSITION for wood & peat - allowing a bed of ash to build up to let the air flow across the fire.



OPEN POSITION for coal & smokeless fuels - allowing the air to flow up through the fuel. In this position the open bars facilitate easy ash removal whether burning wood or coal products.



RECIPROCATING GRATE

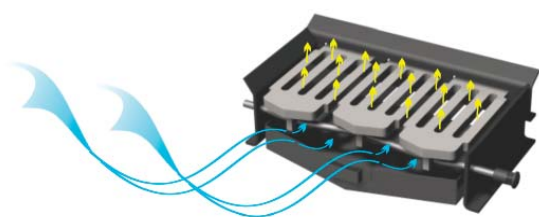

This is an easily fitted, drop in system that converts a Country or C-Series wood-burner into a multi-fuel stove should you wish to burn coal or smokeless fuels. When installed, solid fuel will burn more efficiently by allowing the air to flow under the fire bed. Its neat, external riddling action and ash pan ensure easy cleaning and keep mess to a minimum.

QUATTROFLOW® AIR MANAGEMENT SYSTEM

This is a revolutionary air management system patented by Charnwood and used on the Tor, Cove and Island models. Using 4 air chambers the single control introduces the right amount of air into just the right places for ultra efficient burning and optimum control: pull out to increase the burning rate - push in to slow it down. An optional external air manifold is also available enabling an outside air supply to be channelled directly into the stove through the rear of the Quattroflow® box.

1 PRIMARY air vent: the main control for faster/slower burning

2 SECONDARY air vent for clean glass and double combustion

3 TERTIARY air vent for optimum combustion efficiency

4 BY-PASS air vent reduces condensation when burning overnight



CENTRAL HEATING CONTROL SYSTEM



The Charnwood central heating control system is a pre-wired kit suitable for use with all multi-fuel room heaters, cookers and boilers with a water temperature sensing thermostat. The system gives a fully automatic timed control with built in safety features for your central heating system and can result in significant fuel savings. A high-level pipe thermostat prevents the system boiling by bringing on the pump if the pre-set temperature is reached. The low-limit thermostat cuts out the pump if the water temperature in the boiler falls below the pre-set limit thus cutting down boiler condensation and increasing its life span. The system is completely pre-wired (with exception of the pump cable) comprising of a digital timer, two pipe thermostats, a convenient wiring centre, a cable for the pump and a 13amp plug.

ASH CARRIERS

For clean, safe and effective disposal of ash, an optional ash-carrier is available for all our Cove, Island, C-Series, Country and SLX models.



VERTICAL REAR FLUE ADAPTOR

A vertical rear flue adaptor is available for all Cove, Island, C-Series and Country models.

This enables you to position the stove further out into the

room: away from the wall behind. This will add a depth of 186mm to the stove (168mm to Country 4, C-Four, C-Five & Cove 1: and 220mm to Island III & Cove 3).



HEAT SHIELDS

Charnwood's rear heat shields are designed specifically for situations where space within the fireplace is limited.

The steel shield allows minimum

rear wall clearances to be reduced. The shield is available in a number of sizes for all Cove, Island, C-Series and Country dry models. Speak to your local stockist or visit www.charnwood.com for further details.



EXTERNAL AIR MANIFOLD

The Charnwood external air manifold is a device that enables an outside air supply to be channelled directly into the

stove through the rear of the Quattroflow® box. As well as providing further comfort and operational efficiency for your stove the air manifold helps overcome issues where the room requires an additional air supply for stoves with a rated output in excess of 5kW. It is available for all Cove and Island dry models.



CHARNWOOD COLOUR



black



blue



brown



green



almond



bronze



gunmetal



pewter

In addition to the standard Charnwood matt black, we also offer you a choice of seven other shades. It is a simple yet brilliant way to give the heart of your home a new lease of life. Either order your stove in the colour of your choice or purchase one of our paint kits to re-spray the stove yourself whenever you feel like a change. Charnwood Colour is a specially developed, high temperature stove paint formulated

for an easy application. It is suitable for the following stoves in the Charnwood range: Tor, Cove, Island, Bay, C-Series, Country, Matt finish SLX (Not suitable for the vitreous enamel finish).

Please note: we have reproduced the colours as faithfully as print will allow therefore the pictures should not be taken as an exact indication of colour.



charnwood COMPARISON CHART

	STOVE MODEL																						BOILERS				
	TOR PICO	TOR	BAY 5	BAY 5GT	COVE 1	COVE 2	COVE 3	ISLAND I	ISLAND II	ISLAND IICT	ISLAND III	C-FOUR	C-FIVE	C-SIX	C-SEVEN	C-EIGHT	COUNTRY 4	COUNTRY 6	COUNTRY 8	COUNTRY 12	SLX 20		COVE 2B	ISLAND IIIB	COUNTRY 16B WB	COUNTRY 16B MF	SLX 45
Converting grate																											
Reciprocating grate																											
Quattroflow / Single control																											
Convection fan																											
Charnwood colour																											
Convection panels																											
Vertical rear flue adaptor																											
Heat shield																											
External air manifold																											
Riddling grate & ash tray																											
Soap stone top																											
Stand/ leg options																											
Stay cool handle																											
Removable handle																											
Thermostat control																											
Cleanburn																											
Firebrick lining																											
Fire plate lining																											
Drop-down throat plate																											
Back boiler																											
Flue boiler																											
Front shelf																											
Decorative front fence																											
Canopy																											
Double doors																											
DEFRA exempt																											
Nominal output to room (kW)	5	8	5	5	4	8	12	5	8	8	12	4.9	5	6.7	7.6	8.3	4.8	6	8	12	5.4		4.6	9	7.3	6.4	3.5
Nominal output to boiler (kW)																							6.4	9	8.6	13.2	9.4



charnwood STOVE SELECTOR

The roomset images throughout this brochure and on our website are designed to inspire and help you to visualise different stoves in different settings. To assist you further in realising your own requirement Charnwood have created the Stove Selector. This 3D virtual tool enables you to create your living room online and 'walk' around viewing your stove from every angle and allowing you to see how it complements your decor.



And to help determine what size Charnwood stove you need for your room use the chart below:

www.charnwood.com/stove-selector

CHOOSING YOUR charnwood

When choosing your stove it is important to pick the right size stove for your room by taking into account the RATED OUTPUT: This is the kilowatt output achieved in the European standard tests (EN 13240 and EN13229). Use the chart below or our simple calculator on our website as an initial guide in selecting the most suitable Charnwood stove for your room (dry stoves only). It is based on an outside temperature of -1 °C and a room height of 2.4 metres.

PLEASE NOTE: This is an approximate guide only. Your Charnwood Premier Dealer will be able to

2.5											
3.0											
3.5											
4.0											
4.5											
5.0											
5.5											
6.0											
6.5											
7.0											
7.5											
ROOM SIZE IN METRES	2.5	3.0	3.5	4.0	4.5	5.0	5.5	6.0	6.5	7.0	7.5

	COVE 1, C-FOUR, C-FIVE, COUNTRY 4
	TOR PICO, BAY 5, BAY 5GT, ISLAND I, C-SIX, COUNTRY 6, SLX 20
	TOR, COVE 2, ISLAND II, C-SEVEN, C-EIGHT, COUNTRY 8
	COVE 3, ISLAND III, COUNTRY 12



TOR PICO

DEFRA exempted for burning wood in smoke control areas.

RATED OUTPUT

5kW to room (range 2-7kW)

NET EFFICIENCY

79.2%

FLUE OUTLET

Top only 150mm (6") dia.

MAX LOG LENGTH

300 mm (12")

WEIGHT

160KG

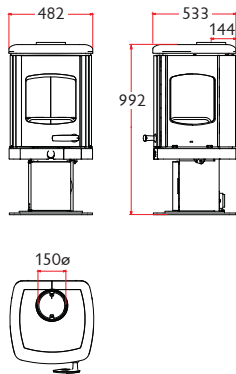

TOR

DEFRA exempted for burning wood in smoke control areas.

RATED OUTPUT

8kW to room (range 3-10kW)

NET EFFICIENCY

73.1%

FLUE OUTLET

Top only 178mm (7") dia.

MAX LOG LENGTH

370 mm (14.5")

WEIGHT

220KG

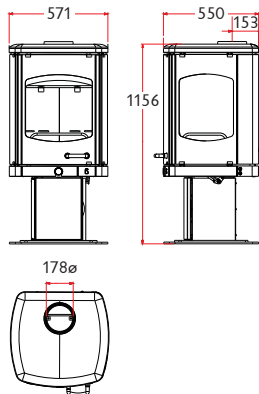

1 COVE

Also available as a DEFRA exempted model for burning wood in smoke control areas. (Cove 1sr)

RATED OUTPUT

4kW to room (range 2-6kW)

NET EFFICIENCY

76.5%

FLUE OUTLET

Top or Rear 125mm (5") dia

MAX LOG LENGTH

300 mm (12")

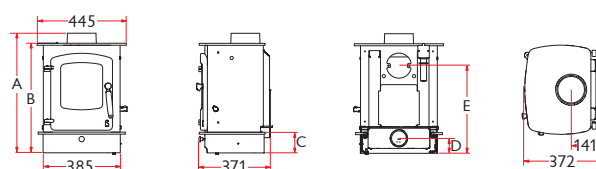

		A	B	C	D	E	WEIGHT
LOW STAND		596	546	103	75	437	89KG
LOW ARCH STAND		596	546	103	75	564	89KG
MIDI STAND		723	673	230	202	564	92KG
STORE STAND		795	745	302	274	636	96KG
CENTRE STAND		795	745	302	274	636	104KG

I ISLAND

DEFRA exempted for burning wood in smoke control areas if fitted with a smoke reduction kit.

RATED OUTPUT

5kW to room (range 2-7kW)

NET EFFICIENCY

77.9%

FLUE OUTLET

Top or Rear 150mm (6") dia

MAX LOG LENGTH

370 mm (14.5")

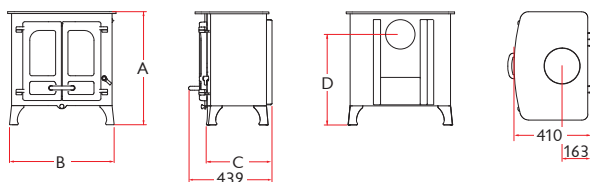

		A	B	C	D	WEIGHT
LOW LEGS		579	533	355	464	130KG
HIGH LEGS		670	551	331	555	133KG
STORE STAND		705	514	299	590	139KG

II ISLAND

DEFRA exempted for burning wood in smoke control areas if fitted with a smoke reduction kit.

RATED OUTPUT

8kW to room (range 5-11kW)

NET EFFICIENCY

78%

FLUE OUTLET

Top or Rear 150mm (6") dia

MAX LOG LENGTH

440 mm (17")

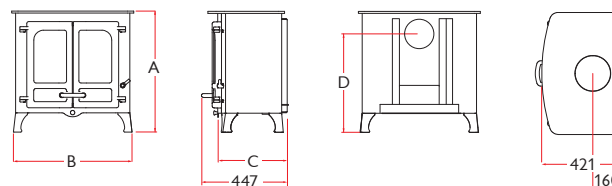

		A	B	C	D	WEIGHT
LOW LEGS		619	605	365	504	140KG
HIGH LEGS		710	622	365	595	143KG
STORE STAND		820	584	301	705	154KG

2 COVE

Also available as a DEFRA
exempted model for burning wood
in smoke control areas. (Cove 2sr)

RATED OUTPUT

8kW to room (range 3-10kW)

NET EFFICIENCY

74.7%

FLUE OUTLET

Top or Rear 150mm (6") dia

MAX LOG LENGTH

370 mm (14.5")

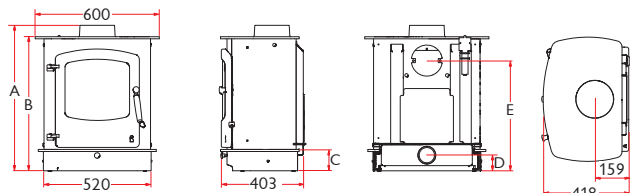

		A	B	C	D	E	WEIGHT
LOW STAND		697	647	103	76	532	127KG
LOW ARCH STAND		697	647	103	76	532	127KG
MIDI STAND		824	774	230	203	659	130KG
STORE STAND		944	894	350	323	779	133KG
CENTRE STAND		944	894	350	323	779	146KG

3 COVE

RATED OUTPUT

12kW to room (range 7-16kW)

NET EFFICIENCY

78.4%

FLUE OUTLET

Top or Rear 178mm (7") dia

MAX LOG LENGTH

500 mm (20")

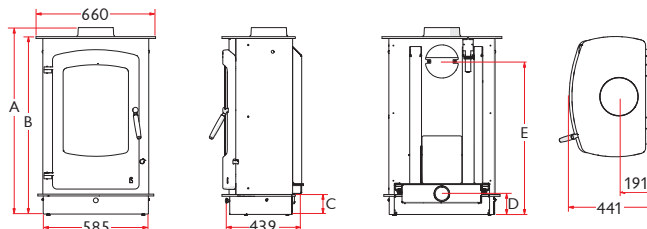

		A	B	C	D	E	WEIGHT
LOW STAND		1130	980	110	115	844	159KG
LOW ARCH STAND		1130	980	110	115	844	159KG
MIDI STAND		1200	1150	280	285	1014	168KG
STORE STAND		1330	1280	410	415	1144	171KG
CENTRE STAND		1330	1280	410	415	1144	187KG

II_{ct} ISLAND

DEFRA exempted for burning
wood in smoke control areas if
fitted with a smoke reduction kit.

RATED OUTPUT

8kW to room (range 5-11kW)

NET EFFICIENCY

79%

FLUE OUTLET

Rear 150mm (6") dia

MAX LOG LENGTH

440 mm (17")

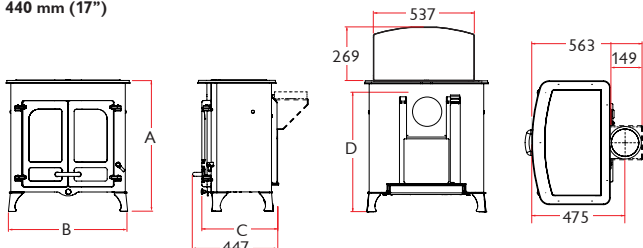

		A	B	C	D	WEIGHT
LOW LEGS		668	605	392	610	156KG
HIGH LEGS		759	622	392	700	159KG
STORE STAND		870	584	392	810	170KG

III ISLAND

DEFRA exempted for burning
wood in smoke control areas if
fitted with a smoke reduction kit.

RATED OUTPUT

12kW to room (range 8-16kW)

NET EFFICIENCY

76.4%

FLUE OUTLET

Top or Rear 178mm (7") dia

MAX LOG LENGTH

550 mm (21.5")

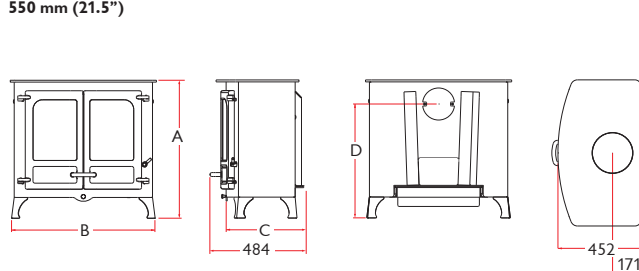

		A	B	C	D	WEIGHT
LOW LEGS		713	732	400	588	180KG
HIGH LEGS		795	750	400	670	184KG
STORE STAND		945	714	309	820	197KG

BAY 5

DEFRA exempted for burning wood in smoke control areas.

RATED OUTPUT

5kW to room (range 2-7kW)

NET EFFICIENCY

80%

FLUE OUTLET

Top only **150mm (6")** dia.

MAX LOG LENGTH

480mm (19")

WEIGHT

85KG

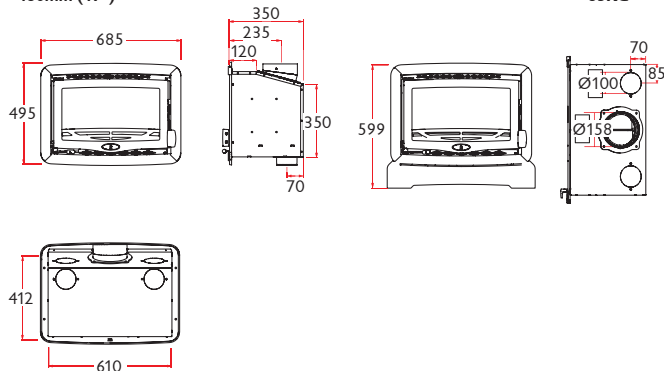

DEFRA exempted for burning wood in smoke control areas.

RATED OUTPUT

4.9kW to room (range 2-5.5kW)

NET EFFICIENCY

78.3%

FLUE OUTLET

Top or Rear **125mm (5")** dia

MAX LOG LENGTH

255mm (10")

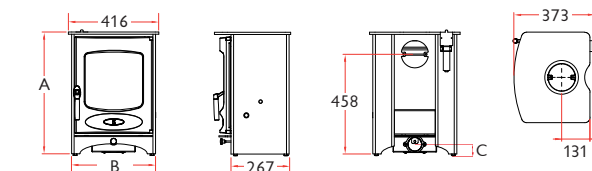

		A	B	C	WEIGHT
LOW LEGS		560	386	45	83KG
STORE STAND		710	386	195	89KG

BAY 5GT

DEFRA exempted for burning wood in smoke control areas.

RATED OUTPUT

5kW to room (range 2-7kW)

NET EFFICIENCY

80%

FLUE OUTLET

Top only **150mm (6")** dia.

MAX LOG LENGTH

480mm (19")

WEIGHT

105KG

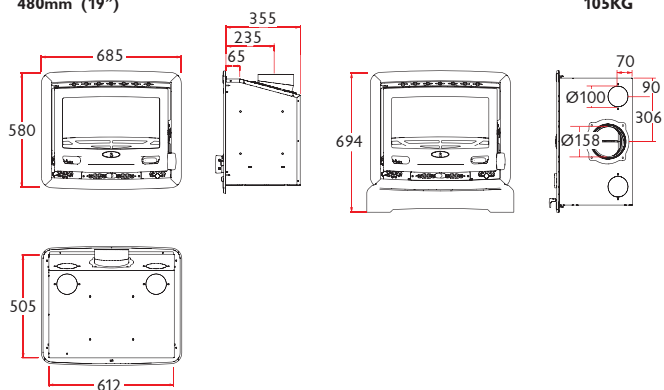

DEFRA exempted for burning wood in smoke control areas.

RATED OUTPUT

7.6kW to room (range 6-8kW)

NET EFFICIENCY

76.9%

FLUE OUTLET

Top or Rear **150mm (6")** dia

MAX LOG LENGTH

380mm (15")

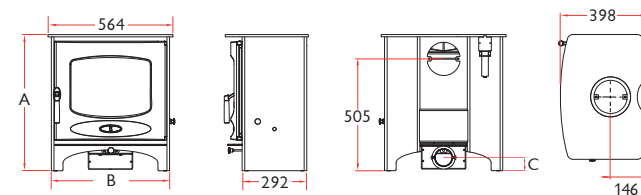

		A	B	C	WEIGHT
LOW LEGS		615	534	59	115KG
STORE STAND		800	534	244	124KG

Please note that the BAY 5 and 5GT outputs and dimensions are subject to final confirmation.



DEFRA exempted for
burning wood in smoke
control areas.

RATED OUTPUT

5.0kW to room (range **2-5.5kW**)

NET EFFICIENCY

75.7%

FLUE OUTLET

Top or Rear **125mm (5")** dia

MAX LOG LENGTH

305mm (13")

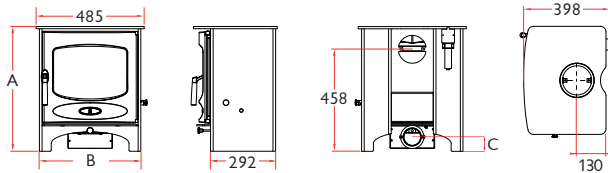

		A	B	C	WEIGHT
LOW LEGS		560	455	65	96KG
STORE STAND		745	455	250	104KG



DEFRA exempted for
burning wood in smoke
control areas.

RATED OUTPUT

6.7kW to room (range **5-7kW**)

NET EFFICIENCY

81.9%

FLUE OUTLET

Top or Rear **150mm (6")** dia

MAX LOG LENGTH

255mm (10")

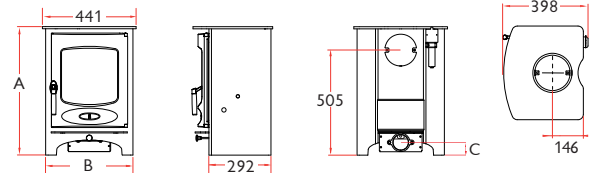

		A	B	C	WEIGHT
LOW LEGS		605	411	63	96KG
STORE STAND		800	411	245	105KG



DEFRA exempted for
burning wood in smoke
control areas.

RATED OUTPUT

8.3kW to room (range **7-9kW**)

NET EFFICIENCY

78%

FLUE OUTLET

Top or Rear **150mm (6")** dia

MAX LOG LENGTH

305mm (13")

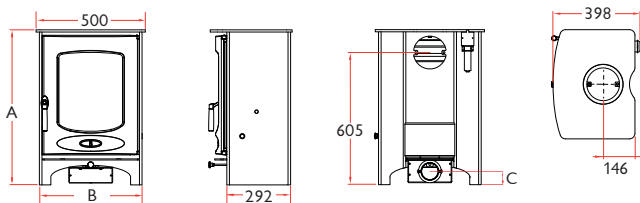

		A	B	C	WEIGHT
LOW LEGS		710	465	61	119KG
STORE STAND		895	470	246	127KG

Full dimensional drawings of the optional canopies and details of other accessories are available on request.

PLEASE NOTE: The stove installations photographed within this brochure are intended as a guide only - Installation must be carried out by a competent engineer in accordance with Building Regulations and local by-laws. Full details are shown in the Installation & Operating Instructions which are available on request. Charnwood's policy is one of continuous development and we reserve the right to change sizes & specifications without notice.

All Charnwood stoves have been independently certified to conform to EN 13240:2001 (EN 13229:2001 in the case of the Bay). All Tor, Cove, Island and C-Series stoves meet the UK building requirements for installation with a 12mm non-combustible hearth.



4

country

DEFRA exempted
for burning wood in
smoke control areas
if fitted with a smoke
reduction kit.

RATED OUTPUT

4.8kW to room (range 2-5.5kW)

Optional boiler 2.2kW

NET EFFICIENCY

76.8%

FLUE OUTLET

Top or Rear 125mm (5") dia.

MAX LOG LENGTH

330mm (13")*

WEIGHT

62kg

6

country

RATED OUTPUT

6kW to room (range 2-8kW)

Optional boiler 2.9kW

NET EFFICIENCY

80.5%

FLUE OUTLET

Top or Rear 150mm (6") dia.

MAX LOG LENGTH

380 mm (15")

WEIGHT (INC STANDS)

90kg

OPTIONAL CANOPY

Overall H734 W552 D413mm

8

country

RATED OUTPUT

8kW to room (range 4-11kW)

Optional boiler 2.9kW

NET EFFICIENCY

79.8%

FLUE OUTLET

Top or Rear 150mm (6") dia.

MAX LOG LENGTH

380 mm (15")

WEIGHT (INC STANDS)

105kg

OPTIONAL CANOPY

Overall H749 W552 D486mm

12

country

RATED OUTPUT

12kW to room (range 5-14kW)

Optional boiler 2.9kW

NET EFFICIENCY

74.1%

FLUE OUTLET

Top or Rear 150mm (6") dia.

MAX LOG LENGTH

430 mm (17")

WEIGHT (INC STANDS)

121kg

OPTIONAL CANOPY

Overall H793 W633 D472mm

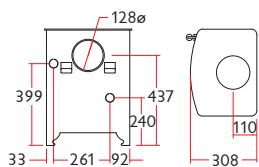
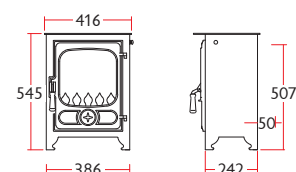

* For DEFRA exemption we recommend
a log length of 250 mm (10")

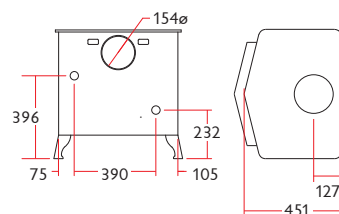
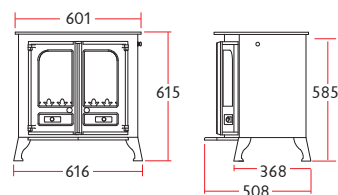
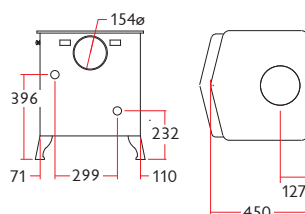
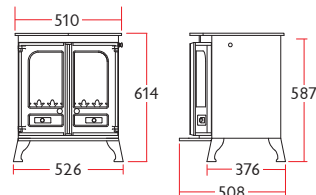
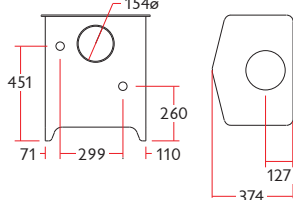
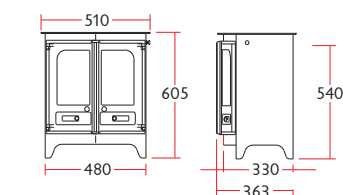

2B COVE

Stand options available.
See page 75

RATED OUTPUT *Wood *Anthracite

Room **4.6kW** (range 2-5kW) / Boiler **6.4kW**

Room **7.1kW** (range 2-8kW) / Boiler **9.3kW**

HEATING CAPACITY *Wood *Anthracite

DHW & approx. **5 radiators** / **7 radiators**

Also suitable for underfloor heating

NET EFFICIENCY

74.6% / 76.5%

FLUE OUTLET

Top or Rear **150mm (6")** dia

MAX LOG LENGTH

370mm (14.5")

WEIGHT

145kg

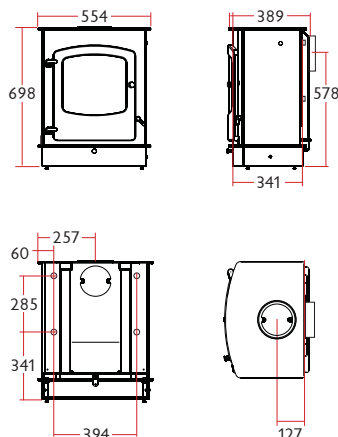

IIIb ISLAND

Stand options available.
See page 75

RATED OUTPUT

To room **9kW** (range 4-9kW)

To int. boiler **9kW**

HEATING CAPACITY

DHW & approximately **6-9 radiators**

Also suitable for underfloor heating

NET EFFICIENCY

73.3%

FLUE OUTLET

Top or Rear **178mm (7")** dia

MAX LOG LENGTH

550mm (21.5")

WEIGHT

190kg

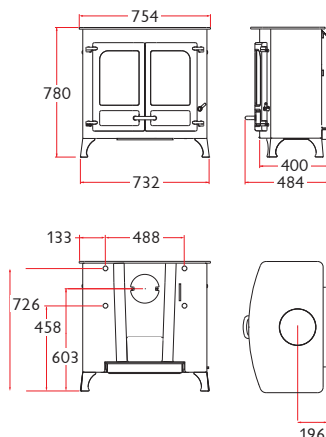

16^b country

Optional Canopy:
Overall dims
H928
W633
D472mm

RATED OUTPUT WOOD BURNER

To room **7.3kW** (range 2-8kW)

To int. boiler **8.6kW**

HEATING CAPACITY

DHW & approximately **7 radiators**

Also suitable for underfloor heating

NET EFFICIENCY

75%

FLUE OUTLET

Top or Rear **150mm (6")** dia.

MAX LOG LENGTH

400 mm (16")

WEIGHT

180kg

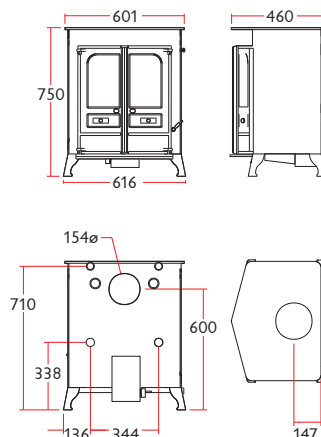

16^b country

Optional Canopy:
Overall dims
H928
W633
D472mm

RATED OUTPUT MULTI FUEL

To room **6.4kW** (range 2-8kW)

To int. boiler **13.2kW**

HEATING CAPACITY

DHW & approximately **10 radiators**

Also suitable for underfloor heating

NET EFFICIENCY

74.6%

FLUE OUTLET

Top or Rear **150mm (6")** dia.

MAX LOG LENGTH

400 mm (16")

WEIGHT

180kg

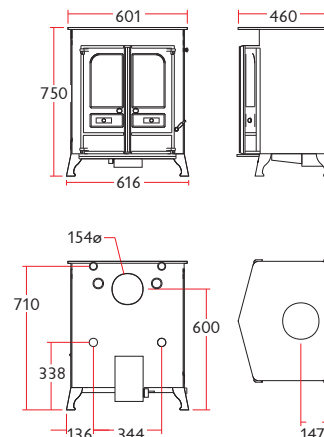

20i SLX

For an optional
boiler 2x1" BSP male
connections may be
fitted either left or right.
Max working head
15.2m (50ft)

RATED OUTPUT *Wood *Solid fuel

To room **5.8kW** (range 2-5kW) **6.3kW**

To optional boiler **2.3kW**

NET EFFICIENCY

75.7% 72.1%

FLUE OUTLET

150mm (6") dia. • **150°** elbow required

MAX LOG LENGTH

280 mm (11")

WEIGHT

125kg

THERMOSTAT

Body temperature sensing

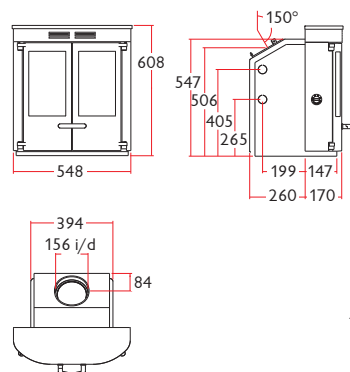

20fs SLX

For an optional
boiler 2x1" BSP male
connections may be
fitted either left or
right. Max working
head 15.2m (50ft)

RATED OUTPUT *Wood *Solid fuel

To room **5.8kW** (range 2-5kW) **6.3kW**

To optional boiler **2.3kW**

NET EFFICIENCY

75.7% 72.1%

FLUE OUTLET

150mm (6") dia.

MAX LOG LENGTH

280 mm (11")

WEIGHT

130kg

THERMOSTAT

Body temperature sensing

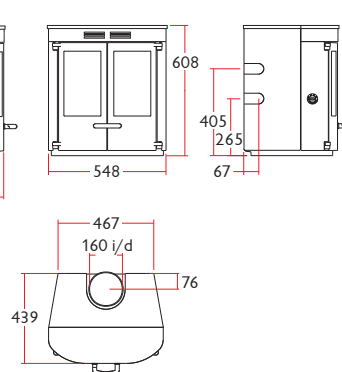

45i SLX

RATED OUTPUT *Wood *Solid fuel

To room **6.0kW** (range 4-7kW) **4.6kW**

To water **6.3kW** (range 4-7kW) **9.7kW**

HEATING CAPACITY

DHW & approximately **8-9 radiators**

Also suitable for underfloor heating

FLUE OUTLET

150mm (6") dia.

MAX LOG LENGTH

370 mm (14.5")

WEIGHT

135kg

THERMOSTAT

Boiler temperature sensing

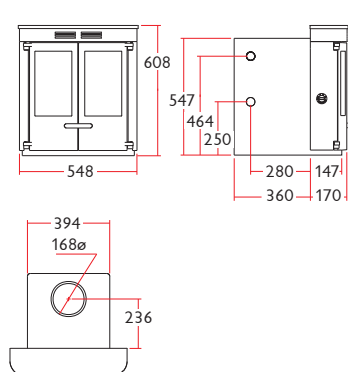

45fs SLX

RATED OUTPUT *Wood *Solid fuel

To room **6.0kW** (range 4-7kW) **4.6kW**

To water **6.3kW** (range 4-7kW) **9.7kW**

HEATING CAPACITY

DHW & approximately **8-9 radiators**

Also suitable for underfloor heating

FLUE OUTLET

150mm (6") dia.

MAX LOG LENGTH

370 mm (14.5")

WEIGHT

140kg

THERMOSTAT

Boiler temperature sensing

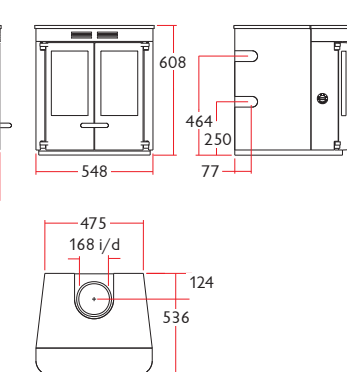



Charnwood is a division of A.J Wells & Sons Ltd which has a further 3 sister companies: A.J Wells & Sons Signage and Cladding (commercial vitreous enamelling and signage division), Anki Chimney Systems and Bodj Fair Trade Fireside. The latter two products are sold alongside Charnwood stoves. For further information on these please contact your local stockist, call us direct on 01983 537780 or visit • www.anki.co.uk • www.bodj.co.uk • www.ajwells.com



A good chimney
makes the world
of difference

to the efficiency of your fire or stove and is indeed paramount to the safety of your home. Whether you are embarking on a new build project, wishing to add a chimney to an existing property or simply want to re-line an existing chimney, ANKI Chimneys have a system to suit virtually all applications. It is the simplest and most cost effective way of building a chimney.

Made from Icelandic volcanic rock ANKI chimney is a product with exceptional insulation and longevity and one that is suitable for all fuel types and guarantees:

- *Minimum heat loss, maximum efficiency*
- *Improved performance for your appliance*
- *Ideal for timber framed & thatched homes*
- *Better chimney draught*
- *Less soot & tar build-up*
- *Chimney fire safe*

For further information ask for our separate ANKI brochure or visit www.anki.co.uk

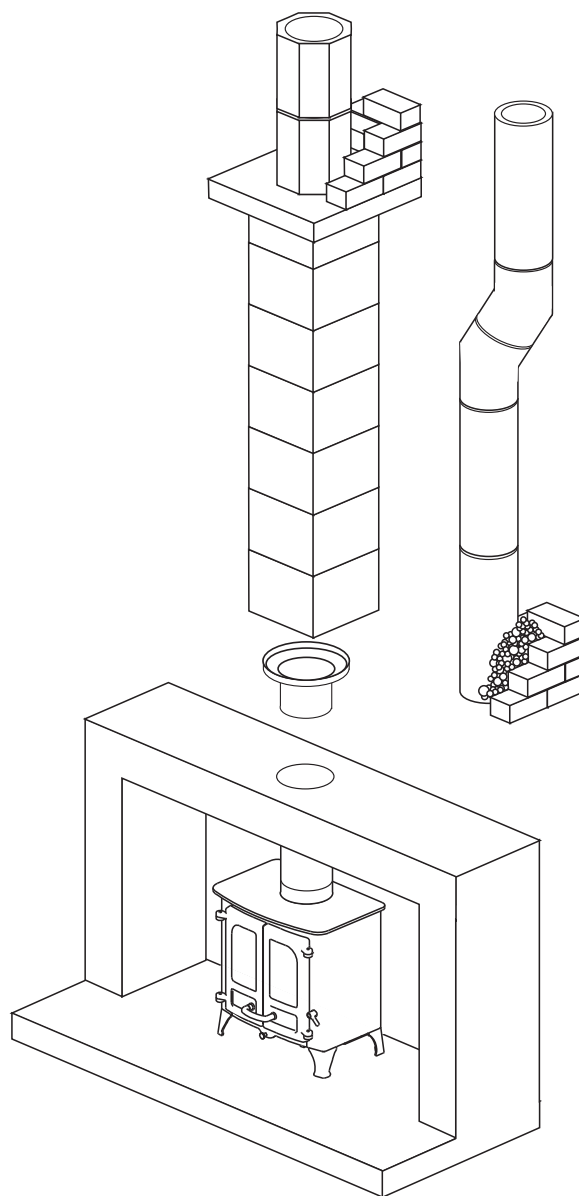

SINGLE MODULE

ANKI single module blocks are a quick, simple and cost effective way to incorporate a first class chimney into a property. This space saving block is ideal for new build projects (especially timber framed properties) or new chimneys to existing properties. The single module consists of a chimney block with an integral liner.

ROUND LINER

ANKI round liner is ideal for the re-lining of existing chimneys. It effectively renews the chimney completely from top to bottom, sealing off any cracking and leakage in the chimney stack and improving the overall stability of the chimney. Anki round liners are available in a wide range of sizes.



Bodj is a fair trade programme exclusive to Charnwood stoves. The initiative sells handmade terracotta tiles and a selection of fireside accessories manufactured by a number of small developing businesses

in Cambodia, South East Asia. We currently work alongside and support three projects each producing unique products using traditional techniques and from ecologically and locally sourced materials. Our aim is to make a difference to these communities: to actively encourage and celebrate their cultural skills whilst ensuring fair wages and responsible trading practices.



bodj n. taken from the French name for Cambodia: 'Cambodge'



BASKETWARE PROJECT

The Bodj basketware initiative supports a number of basket weaving projects on the outskirts of Phnom Penh and in the Cambodian province of Kratie. A mixture of indigenous materials are used from bamboo and rattan to rush and water hyacinth. Age old weaving techniques are used to create a variety of traditional and adapted designs including log baskets and brushes.

IRONWORK PROJECT

Bodj ironwork products are made by an ironworking initiative based in Phnom Penh. The project trains up a number of young people from disadvantaged backgrounds with the design and fabrication overseen by a Swiss design engineer. Traditional skills are mixed with Khmer inspired designs to create a variety of log holders and companion sets.

RECYCLING PROJECT

The Bodj recycled products are produced by a project based in the Kompong Thom province of Cambodia. Colourful rice sacks are recycled into unstructured log and kindling buckets.



All the Bodj projects are kept deliberately small-scale with working practices within the communities carefully monitored so as not to disturb the eco-system in which the craftsmen and women live. The production processes of many of the products are also dictated by monsoons therefore availability is sometimes limited. For more information on the full range of products and projects speak to your local stockist or visit the website www.bodj.co.uk



